

# HEAVY DUTY FLAIL MOWER

<http://tiny.cc/HDflailmower>

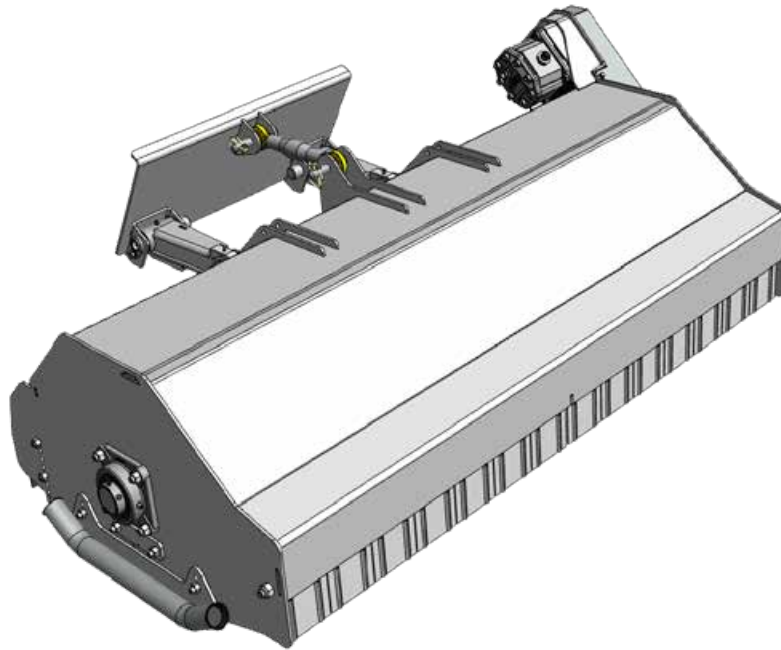

## FEATURES & BENEFITS

- Heavy duty tools
- Perfect for thick grass, sticks, undergrowth and pruning residues, roadside maintenance
- New floating system

The Heavy Duty flail mower is now stronger and more powerful for maintaining more rugged landscape areas including heavy grasses, storm debris, sticks, pruning residues and more around farms, properties, parklands, and roadsides.

The hammer <sup>(1)</sup> shaft set-up is especially designed to withstand to heavy works, such as cutting shrubs up to a diameter of 10 cm.

The rear support roller, adjustable in height, make this tool extremely effective and allow the operator to choose the desired cutting height.

The new floating system permits to follow the ground contours in an effective way also on uneven lawns.

**Note: suggested floating boom valve on machine.**

Model	Cutting Width	Cutting Height	Hammers 120 mm	Weight	Code
150	150 cm (59 in)	1-10 cm (0.4-4 in)	18	390 kg (860 lbs)	<b>C890540</b>

